



# INSTRUCTION BULLETIN

No. 9015097  
Machine: M17  
Published: 10-2017  
Rev. 00

**NOTE: DO NOT DISCARD the Parts List from the Instruction Bulletin. Place the Parts List in the appropriate place in the machine manual for future reference. Retaining the Parts List will make it easier to reorder individual parts and will save the cost of ordering an entire kit.**

*NOTE: Numbers in parenthesis ( ) are reference numbers for parts listed in Bill of Materials.*

Installation instructions for **kit number 9015026**

## SYNOPSIS:

This kit contains the parts needed to replace the sweep skirts on M17 sweeper scrubbers.  
Please follow step-by-step instructions.

## SPECIAL TOOLS / CONSIDERATIONS: NONE

(Estimated time to complete: 30 minutes)

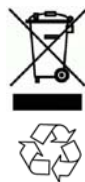

### PROTECT THE ENVIRONMENT

Please dispose of packaging materials, used machine components such as batteries and fluids in an environmentally safe way according to local waste disposal regulations.

Always remember to recycle.

## PREPARATION:

**FOR SAFETY: Before leaving or servicing machine, stop on level surface, turn off machine, set parking brake, and remove key.**

1. Remove the left brush cover panel from the machine. Set the left brush cover panel and mounting hardware aside. (Fig. 1)

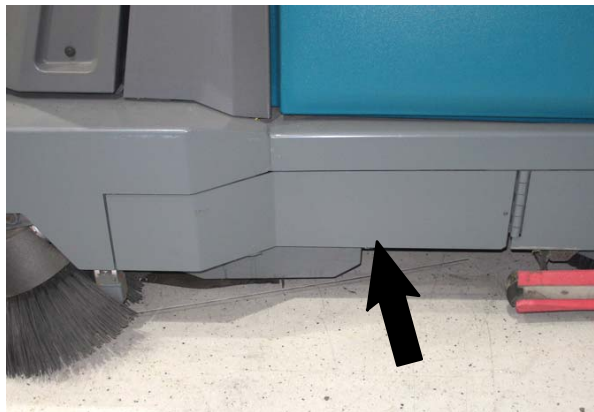

FIG. 1

2. Open the right panel plate. (Fig. 2)



FIG. 2

## INSTALLATION:

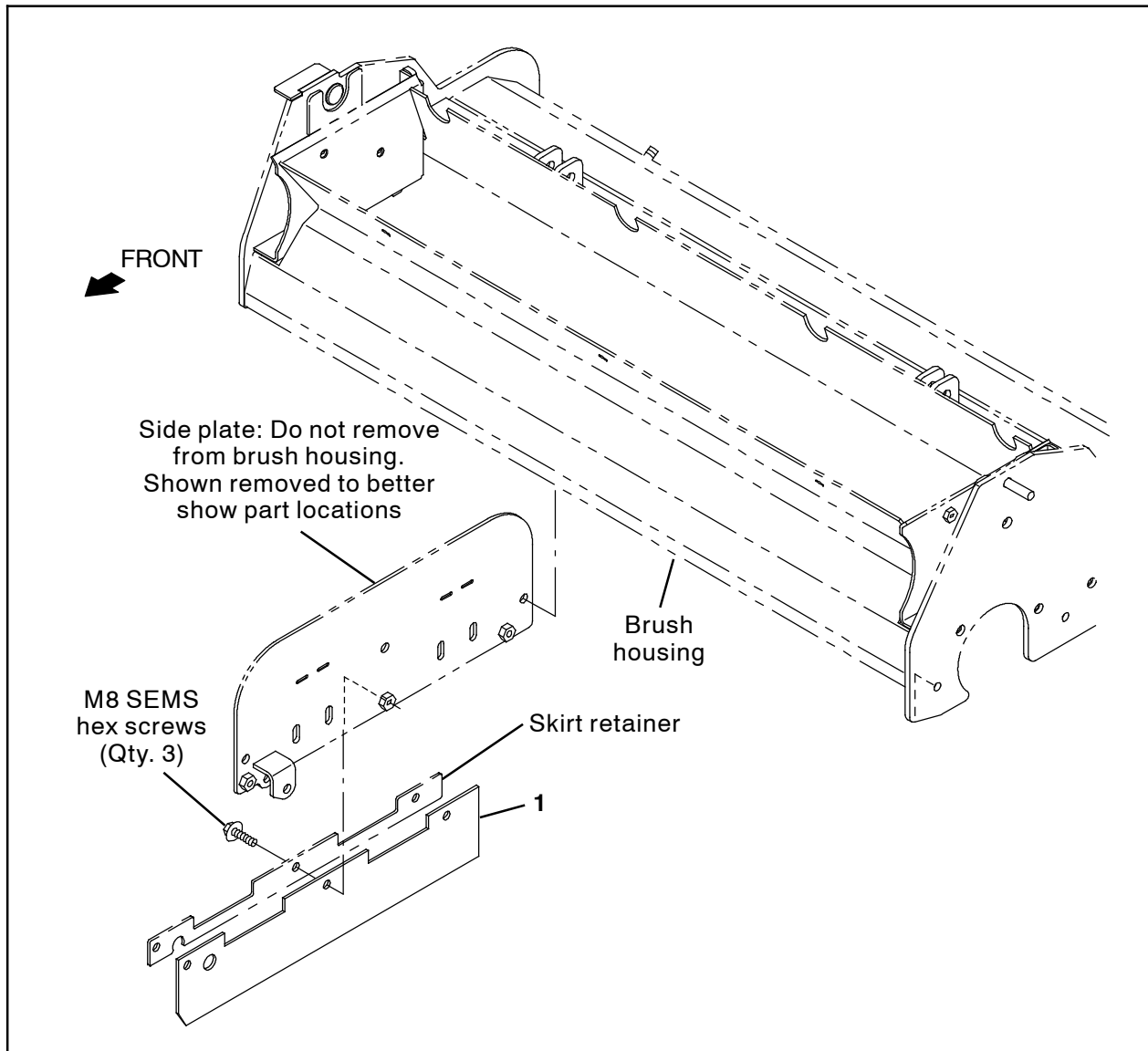

**FIG. 3**

1. Remove the three M8 SEMS hex screws securing the skirt retainer and right sweep skirt to the side plate. Set the M8 SEMS hex screws and skirt retainer aside. Discard the right skirt. (Fig. 3)
2. Use the three M8 SEMS hex screws and skirt retainer to install the new right sweep skirt (1) onto the side plate. (Fig. 3)

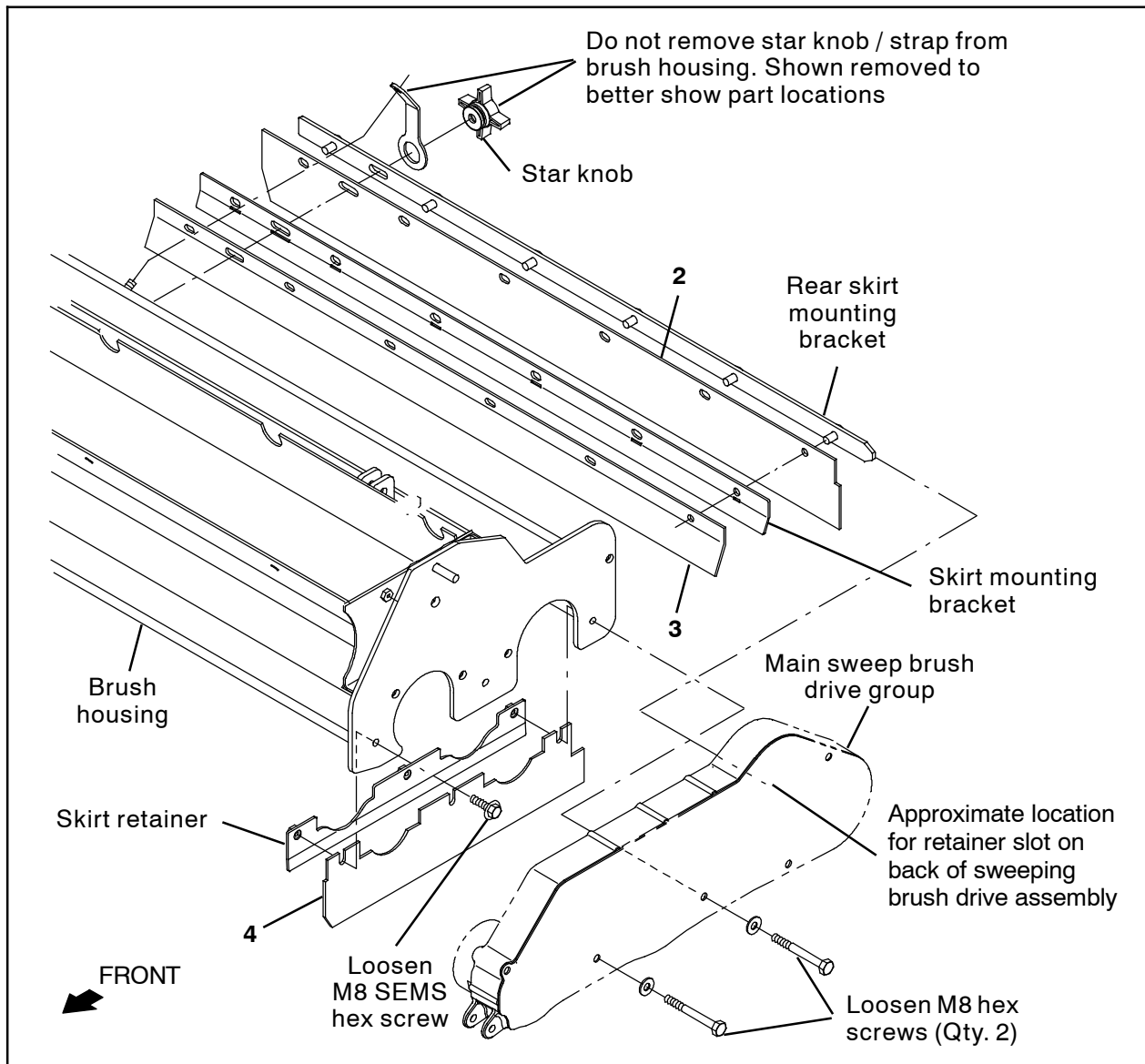

**FIG. 4**

3. Loosen the star knob securing the rear skirt mounting bracket, the rear skirt, the skirt mounting bracket, and the recirculation skirt to the brush housing. Set the two brackets aside. Discard the rear skirt and recirculation skirt. (Fig. 4)
4. Assemble the new rear skirt (2) and new recirculation skirt (3) onto the rear skirt mounting bracket and skirt mounting bracket. (Fig. 4)
5. Insert the tab end of the skirt mounting bracket into the retainer slot in the sweeping brush drive assembly and install the skirt assembly assembled in the previous step onto the brush housing. Use the star knob to secure the skirt assembly to the brush housing. (Fig. 4)
6. Loosen (do not remove) both M8 hex screws and the M8 SEMS hex screw securing the left sweep skirt and skirt retainer to the brush housing. (Fig. 4)
7. Remove the left sweep skirt from between the brush housing and the main sweep brush drive group. Discard the left sweep skirt. (Fig. 4)
8. Insert the new left sweep skirt (4) between the skirt retainer and brush drive housing and tighten both M8 hex screws and the M8 SEMS hex screw to secure the left skirt into place. (Fig. 4)
9. Reinstall the left brush cover panel onto the machine.

---

**Bill Of Materials For Skirt Kit, Swp, Afmkt [M17] - 9015026**

<b>Ref.</b>	<b>Tennant Part No.</b>	<b>Description</b>	<b>Qty.</b>
1	1219071	Skirt, Sweep, RH	1
2	1218918	Skirt, HD, Sweep, Rear	1
3	1219236	Skirt, Recycle	1
4	1219033	Skirt, HD, Sweep, LH	1

TENNANT COMPANY  
P. O. Box 1452  
Minneapolis, MN 55440-1452